

INDEX

| SHEET NO. | TITLE SHEET |
|-----------|---|
| 1 | TYPICAL CROSS SECTIONS. |
| 2 | STANDARD CROSS SECTIONS. |
| 3 | STD. EXPANSION JOINTS (Rev. June 7, 1935) |
| 4 | STD. PAVEMENT JOINTS (Rev. June 7, 1935) |
| 5 | PLAN AND PROFILE. |
| 6 | BRIDGE AND CULVERT DATA—ESTIMATE OF QUANTITIES. |
| 7 | MISCELLANEOUS STANDARDS SHEET 'A' (FEB. 1935) |
| 8 | MISCELLANEOUS STANDARDS SHEET 'D' (FEB. 1935) |
| 9 | STD. REIN. CONC. BOX CULVERT (Rev. Jan. 11, 1935) |
| 10 | STD. REIN. CONC. CULV.—SLAB TOP TYPE WITHOUT FILL (10'-0" TO 18'-0" SPAN) |
| 11 | STD. REIN. CONC. CULV.—SLAB TOP TYPE UNDER FILL 1'-0" TO 5'-0" (10'-0" TO 20'-0" SPAN) |
| 12 | STD. REIN. CONC. CULV.—SLAB AND GIRDER WITHOUT FILL (20'-0" SPAN) |
| 13 | STD. REIN. CONC. CULV.—SLAB TOP TYPE WITHOUT FILL (10'-0" TO 20'-0" SPAN) 15° SKEW. |
| 14 | STD. REIN. CONC. CULV.—SLAB TOP TYPE WITHOUT FILL (10'-0" TO 20'-0" SPAN) 30° SKEW. |
| 15 | STD. REIN. CONC. CULV.—SLAB TOP TYPE WITHOUT FILL (10'-0" TO 20'-0" SPAN) 45° SKEW. |
| 16 | STD. REIN. CONC. CULV.—SLAB TOP TYPE WITHOUT FILL (10'-0" TO 20'-0" SPAN) 60° SKEW. |
| 17 | STD. REIN. CONC. CULV.—SLAB TOP TYPE WITHOUT FILL (10'-0" TO 20'-0" SPAN) GRAVITY TYPE. |
| 18 | STD. FLEXIBLE STEEL PLATE GUARD RAIL (May, 1935) |
| 19 | STD. RAILROAD GRADE CROSSING. |
| 20 | STD. PLAN FOR FILLING IN PEAT MARSHES. |
| 21 | DATA FOR SUPER-ELEVATING AND WIDENING OF CURVES (SEPT. 1932) |
| 22 | STD. DETOUR SIGNS SHEET NO. 4-151 SHEET NO. 2 REV. 5/17/51 |
| 23 | CROSS SECTIONS. |

| FEDERAL ROAD DIVISION NO. | STATE | PROJECT NO. | SCALE | SHEET NO. | TOTAL SHEETS |
|---------------------------|-------|-------------|-------|-----------|--------------|
| 4 | IND. | 29(3) | 1951 | 1 | 5 |

SECTION:

STATE OF INDIANA
STATE HIGHWAY COMMISSION

PLAN AND PROFILE OF PROPOSED
STATE HIGHWAY
F. PROJECT NO. 29(3)
EVANSVILLE-VINCENNES ROAD

BEGINNING AT A POINT ON U.S.R. NO. 41 APPROXIMATELY 142.3 FT. SOUTH OF THE NORTH LINE OF SEC. 20, T.1 N. R. 10 W. 3 EXTENDING NORTH ON U.S.R. NO. 41 TO A POINT APPROXIMATELY 1147 FT. NORTH OF THE SOUTH LINE OF SEC. 17, T.1 N. R. 10 W. ALL IN KNOX COUNTY.

GROSS LENGTH: 1.334 MI.
NET LENGTH: 1.334 MI.
SCALES:-
PLAN LONG:- 1"=100' PROFILE HORIZ:- 1"=100'
TRANS:- 1"=100' VERT:- 1"=10' MAX. GRADE:-

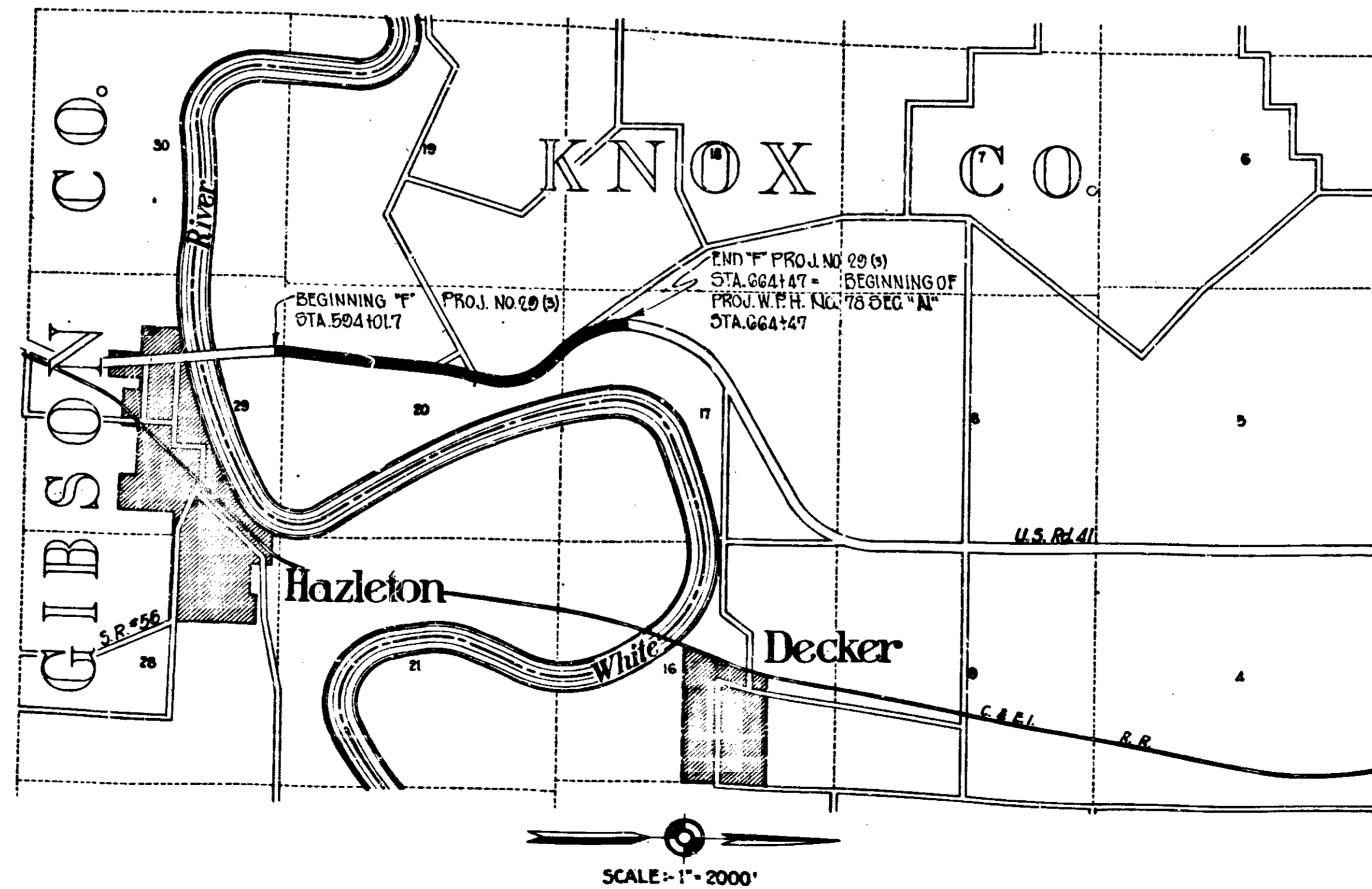

APPROVED AND ADOPTED *May 12, 1951*
By STATE HIGHWAY COMMISSION OF INDIANA
Samuel C. Hadden
CHAIRMAN-STATE HIGHWAY COMMISSION OF INDIANA
APPROVED *May 12, 51*
Frank J. Bowers
CHIEF ENGINEER-STATE HIGHWAY COMMISSION OF INDIANA

DEPARTMENT OF COMMERCE
BUREAU OF PUBLIC ROADS
RECOMMENDED FOR APPROVAL:
DISTRICT ENGINEER DATE
APPROVED:
DIVISION ENGINEER DATE

STATE HIGHWAY COMMISSION OF INDIANA.
STANDARD SPECIFICATIONS
DATED 1946 TO BE USED WITH THESE PLANS.

RECOMMENDED FOR APPROVAL *5-14-51*

W. H. Behrens
MEMBER OF ROAD DESIGN-STATE HIGHWAY COMMISSION OF INDIANA

| FEDERAL ROAD DIVISION NO. | STATE | PROJ. NO. | FISCAL YEAR | SHEET NO. | TOT. L. SHEETS. |
|---------------------------|-------|-----------|-------------|-----------|-----------------|
| 4 | IND. | 29 (B) | 1951 | 2 | 5 |

SECTION ..

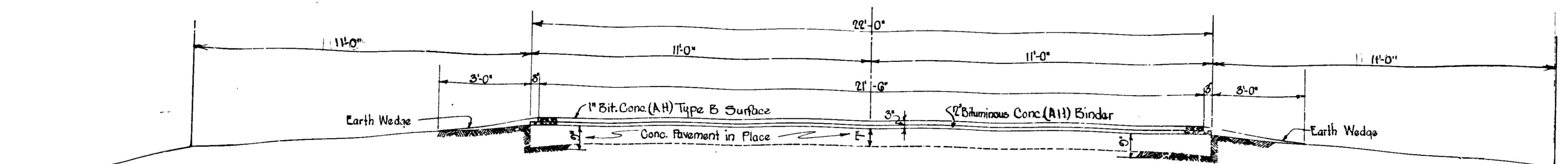

STA. 594+11.7 TO STA. 633+14.5

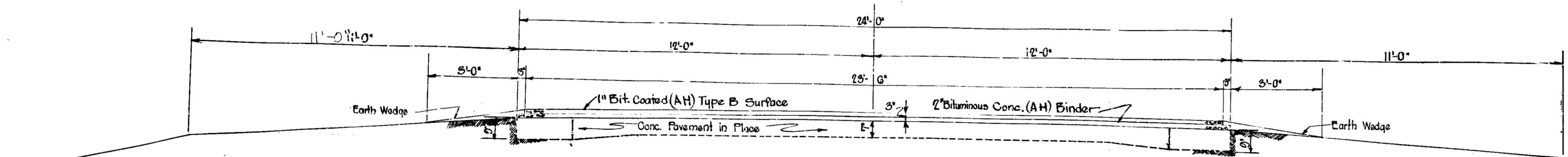

STA. 633+14.5 TO STA. 664+47

FOR PLAN & PROFILE SEE W.P.M. PROJECT 29 SEC. A-1 & "BRIDGE" PROJECT F.A.29

TYPICAL CROSS SECTIONS

SCALE: 1/2" = 1'-0"

APPROVED *Ray H. Bowers* 5/15
CHIEF ENGINEER, STATE HIGHWAY COMMISSION OF INDIANA

RECOMMENDED FOR APPROVAL 5-14-51

APPROVED *Samuel E. Hadden* 5/18/51
CHAIRMAN, STATE HIGHWAY COMMISSION OF INDIANA

W. F. Behrens
ENGINEER OF ROAD DESIGN, STATE HIGHWAY COMMISSION OF INDIANA

