

BRIDGES OVER 20' SPAN					
FEDERAL REGION NO.	STATE	PROJECT NO.	FISCAL YEAR	SHEET NO.	TOTAL SHEETS
5	IND.	DSB-019-0(011)	1992	1	27

INDIANA  
DEPARTMENT OF  
TRANSPORTATION

**BRIDGE PLANS**  
FOR SPANS OVER 20 FEET  
ON  
U.S. 41

PROJECT NO. ST/019-0( ) P.E.  
DSB /019-0(011) R/W  
CONST.  
ROUTE: US 41 AT: RP 188 + 60N  
RP 188 + 60S

REHABILITATION AND OVERLAY TO STRUCTURE NO. 41-86-5923.  
APPROXIMATELY 2,460 FEET EAST OF AND 2,015 FEET SOUTH OF  
THE NORTHWEST CORNER OF SECTION 18, TOWNSHIP 23 NORTH,  
RANGE 8 WEST, IN WARREN COUNTY, INDIANA.

NOTE:  
WHENEVER F-019-0(011)  
APPEARS ON THESE PLANS OR CONTRACT DOCUMENTS  
IT SHALL BE INTERPRETED AS DSB-019-0(011)

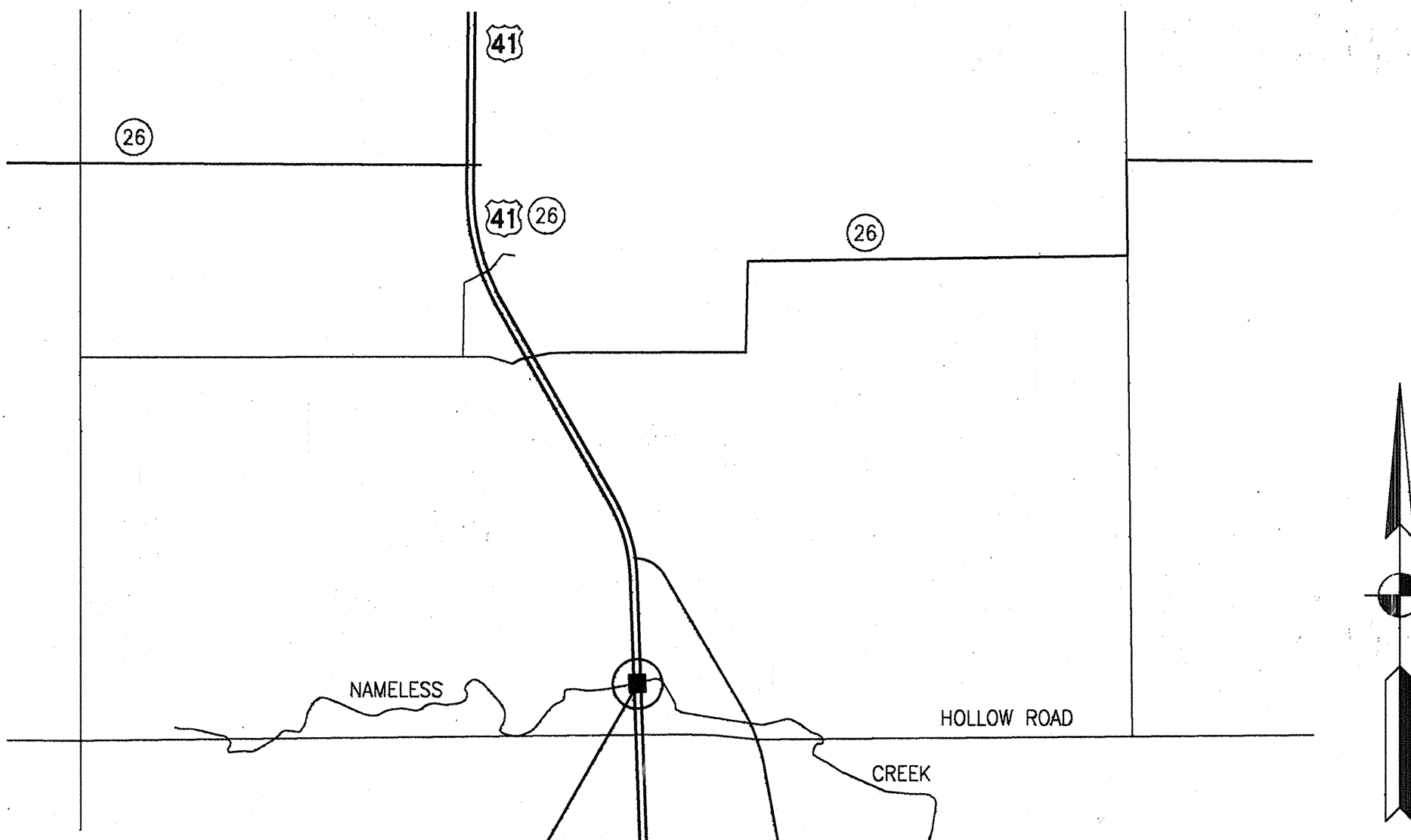

REHABILITATION AND OVERLAY TO STR. 41-86-5923  
SCALE: 1" = 2000'

INDEX					
PROJECT	STRUCTURE	TYPE	SPAN	OVER	STATION
DSB-019-0(011)	41-86-5923A	CONTINUOUS PRESTRESSED CONCRETE I-BEAM.	3 @ 37'-0"	NAMELESS CREEK	
SHEET NO.	SHEET DESIGNATION	SUBJECT			F.H.W.A. APPROVAL
1	ONE SHEET	TITLE SHEET AND INDEX			
2,3	TWO SHEETS	TRAFFIC MAINTENANCE DETAILS			
4	D-1	DITCH RECONSTRUCTION DETAILS			
5	D-2	GENERAL PLAN			
6	D-3	SUPERSTRUCTURE DETAILS			
7	D-4	SUPERSTRUCTURE DETAILS AND BILL OF MATERIALS			
8	D-5	APPROACH DETAILS			

TRAFFIC DATA		EACH DIRECTION	
A.D.T. (1991)	V.P.D.	2,600	V.P.D.
A.D.T. (20 PROJECTED)	V.P.D.		V.P.D.
D.H.V. (20 PROJECTED)	V.P.D.		V.P.D.
TRUCKS	D.H.V. % A.D.T. %	D.H.V. % A.D.T. %	
POSTED SPEED	M.P.H.	55	M.P.H.
ACCESS CONTROL			
FUNCTIONAL CLASSIFICATION		RURAL ARTERIAL	

INDEX CONTINUED STANDARD DRAWINGS					
SHEET NO.	SHEET DESIGNATION	SUBJECT	PURPOSE/USE	F.H.W.A. APPROVAL	ADOPTED "A" REVISION "R"
9	BRIDGE STD. BR-1	CONCRETE BRIDGE RAILING TRANSITION TYPE TGB	CONCRETE BRIDGE RAILING TYPE TGB	*	A AUG. 1992
10	BRIDGE STD. BR-1A	CONCRETE BRIDGE RAILING TRANSITION TYPE TGB	PLATE WASHER, G.R. ATTACHMENT, EXTENSION DETAILS	*	A AUG. 1992
	BRIDGE STD. BR-2	CONCRETE BRIDGE RAILING TRANSITION TYPE WGB			
	BRIDGE STD. BR-2A	CONCRETE BRIDGE RAILING TRANSITION TYPE WGB			
11	BRIDGE STD. C1	MISCELLANEOUS DETAILS	REINFORCING BAR NOTES, BAR BENDING DETAILS	11-22-91	R 10-01-91
	BRIDGE STD. C2	MISCELLANEOUS DETAILS			
12	BRIDGE STD. C3	MISCELLANEOUS DETAILS	MISC. JOINT DETAILS	01-26-88	R 11-02-87
	BRIDGE STD. C4	PRESTRESSED CONCRETE PILES			
	BRIDGE STD. C5	PRECAST DECK PANEL DETAILS			
	BRIDGE STD. D	CASTING DETAILS AND ROADWAY DRAINS			
	BRIDGE STD. D1	ADJUSTING FRAME DETAILS FOR ROADWAY DRAINS			
	BRIDGE STD.	PRESTRESSED CONCRETE			
	BRIDGE STD.	PRESTRESSED CONCRETE			
	BRIDGE STD. PB10	TOLERANCES FOR FABRICATION OF PRESTRESSED BEAMS			
	BRIDGE STD. PB11	ELASTOMERIC BEARING PADS FOR CONCRETE BEAMS			
	BRIDGE STD. R2B	BRIDGE LIGHTING DETAILS			
	BRIDGE STD. S1	MISCELLANEOUS DETAILS			
	BRIDGE STD. SH1	STEEL SHOE DETAILS			
	BRIDGE STD. SS-1	EXPANSION JOINTS CLASS-SS			
	BRIDGE STD. SS-2	EXPANSION JOINTS CLASS-SS			
	BRIDGE STD. T SHEET A	STANDARD TEMPORARY BRIDGE			
	BRIDGE STD. T SHEET B	STANDARD TEMPORARY BRIDGE			
	ROAD STD. SHEET A	STANDARD PAVEMENT JOINTS			
13	ROAD STD. SHEET B	STANDARD PAVEMENT JOINTS	R.C. BRIDGE APPROACH DETAILS	05-01-90	R 03-01-90
	ROAD STD. SHEET MA	MISCELLANEOUS STANDARDS			
	ROAD STD. SHEET MB	MISCELLANEOUS STANDARDS			
	ROAD STD. SHEET MB-2	MISCELLANEOUS STANDARDS			
	ROAD STD. SHEET MB-4	MISCELLANEOUS STANDARDS			
	ROAD STD. SHEET MC	MISCELLANEOUS STANDARDS			
	ROAD STD. SHEET MC-1	MISCELLANEOUS STANDARDS			
	ROAD STD. SHEET MD	MISCELLANEOUS STANDARDS			
	ROAD STD. SHEET MD	MISCELLANEOUS STANDARDS			
	ROAD STD. SHEET MD	MISCELLANEOUS STANDARDS			
	ROAD STD. SHEET ME	MISCELLANEOUS STANDARDS			
	ROAD STD. SHEET ME	MISCELLANEOUS STANDARDS			
	ROAD STD. SHEET ME	MISCELLANEOUS STANDARDS			
	ROAD STD. SHEET MH	MISCELLANEOUS STANDARDS			
	ROAD STD. SHEET MH-1	MISCELLANEOUS STANDARDS			
	ROAD STD. SHEET MH-2	MISCELLANEOUS STANDARDS			
	ROAD STD. SHEET MI	MISCELLANEOUS STANDARDS			
	ROAD STD. SHEET MI-1	MISCELLANEOUS STANDARDS			
	ROAD STD. SHEET MI-2	MISCELLANEOUS STANDARDS			
	ROAD STD. SHEET MN	MISCELLANEOUS STANDARDS			
	ROAD STD. SHEET MN-1	MISCELLANEOUS STANDARDS			
	ROAD STD. SHEET MP	MISCELLANEOUS STANDARDS			
	ROAD STD. SHEET MQ	MISCELLANEOUS STANDARDS			
	ROAD STD. SHEET MT2	MISCELLANEOUS STANDARDS			
	ROAD STD. SHEET MT3	MISCELLANEOUS STANDARDS			
	ROAD STD. SHEET B-1	TYPICAL BRIDGE APPROACH GUARDRAIL			A AUG 1992
15	ROAD STD. SHEET E-1	GUARDRAIL END TREATMENT TYPE I		07-20-92	A DEC 1991
	ROAD STD. SHEET E-2	GUARDRAIL END TREATMENT TYPE OS			
	ROAD STD. SHEET E-3	GUARDRAIL END TREATMENT TYPE MS		07-20-92	A DEC 1991
17	ROAD STD. SHEET G-1	W-BEAM GUARDRAIL COMPONENTS		*	A AUG 1992
18	ROAD STD. SHEET G-2	THREE-BEAM GUARDRAIL COMPONENTS		07-20-92	A DEC 1991
19	ROAD STD. SHEET G-3	W-BEAM GUARDRAIL ASSEMBLIES		07-20-92	A DEC 1991
	ROAD STD. SHEET H-1	HAZARD PROTECTION GUARDRAIL			
	ROAD STD. SHEET H-2	HAZARD PROTECTION GUARDRAIL			
	ROAD STD. SHEET P-4	PIER PROTECTION GUARDRAIL			
20	ROAD STD. SHEET T-1	GUARDRAIL TRANSITION TYPE GB		*	A AUG 1992
	ROAD STD. SHEET T-2	GUARDRAIL TRANSITION TYPE GP			
	ROAD STD. SHEET T-3	GUARDRAIL TRANSITION TYPE VH			
	ROAD STD. SHEET T-4	PIER CONNECTION DETAILS			
	ROAD STD. SHEET CB-1	CONCRETE MEDIAN BARRIER			
	ROAD STD. SHEET CB-2	TEMPORARY CONCRETE BARRIER		01-11-89	R 09-01-88
22	ROAD STD. SHEET 1 DETOURS	STANDARD DETOUR SIGNS		*	A SEP 1988
	ROAD STD. SHEET 1A DETOURS	STANDARD DETOUR SIGNS			
	ROAD STD. SHEET 1B DETOURS	STANDARD DETOUR SIGNS			
	ROAD STD. SHEET 2 DETOURS	STANDARD DETOUR SIGNS			
23	ROAD STD. SHEET 2A DETOURS	STANDARD DETOUR SIGNS		*	A SEP 1988
24	ROAD STD. SHEET 3 DETOURS	STANDARD DETOUR SIGNS		*	R 09-01-88
25	ROAD STD. SHEET 3A DETOURS	STANDARD DETOUR SIGNS		*	R 09-01-88
26	ROAD STD. SHEET 4 DETOURS	STANDARD DETOUR SIGNS		01-11-89	R 09-01-88
27	ROAD STD. SHEET 5 DETOURS	STANDARD DETOUR SIGNS		*	R 09-01-88
	ROAD STD. SHEET 5A DETOURS	STANDARD DETOUR SIGNS			

\* F.H.W.A. APPROVAL PENDING

PREPARED & RECOMMENDED BY  
**ROAW**  
REID, QUEBE, ALLISON, WILCOX & ASSOCIATES, INC.  
INDIANAPOLIS, INDIANA  
*Raman D. Patel*  
RAMAN D. PATEL P.E.



RECOMMENDED FOR APPROVAL 12-3-92  
*James C. Karp*  
BRIDGE REHABILITATION ENGINEER, INDIANA DEPARTMENT OF TRANSPORTATION

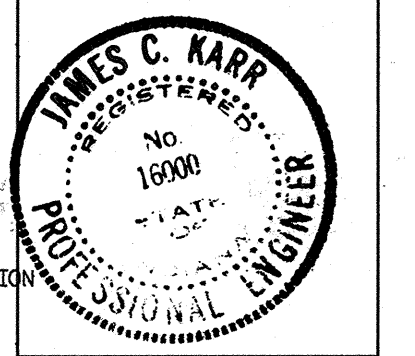

APPROVED 12-10-92  
*Donnell*  
CHIEF DIVISION OF DESIGN -- INDIANA DEPARTMENT OF TRANSPORTATION

RECOMMENDED FOR APPROVAL 12-4-92  
*Thomas H. Seeman*  
DESIGN CONSULTANT SERVICES MANAGER  
INDIANA DEPARTMENT OF TRANSPORTATION

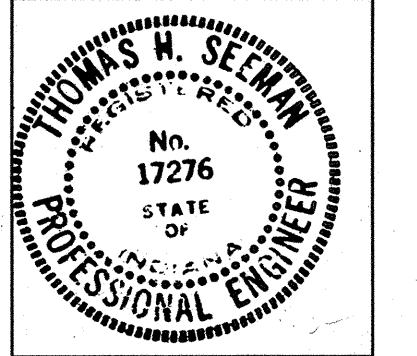

FEDERAL HIGHWAY ADMINISTRATION  
DEPARTMENT OF TRANSPORTATION  
APPROVED: \_\_\_\_\_  
DIVISION ADMINISTRATOR DA'E

REVISIONS	
DATE	SHEET NO.
10-06-92	TITLE SHEET, 2, 3, 5, AND 8

REVISIONS	
DATE	SHEET NO.

INDIANA DEPARTMENT OF HIGHWAYS  
STANDARD SPECIFICATIONS DATED 1988  
TO BE USED WITH THESE PLANS.  
DESIGN NO. 8715605

BRIDGE FILE: 41-86-5923A

C:\ACAD1\WORK\604\91013-RP\3284\TITLESHT.DWG 12-02-91 7:30AM - 8:20AM Scale: 1" = 2000.0000 Time: 10/23/92 at 02:56 D.DUNCAN

B-19919

11-14-91 7:30AM - 12:00PM 4.5 HOURS  
 11-13-91 10:00AM - 4:30PM 5.5 HOURS  
 11-13-91 7:30AM - 9:00AM 1.5 HOURS  
 GKN  
 C:\ACAD\10\WORK\602\328A\SHEET-2.DWG  
 Scale: 1" = 480.0000  
 Time: 11/27/91 at 09:29

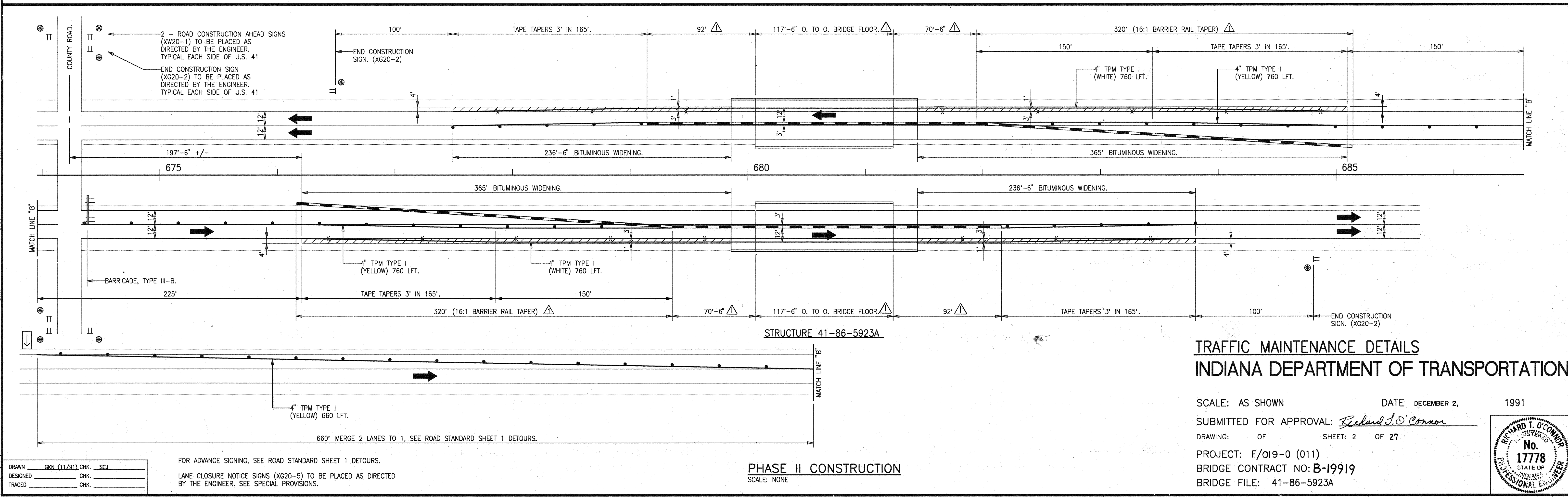
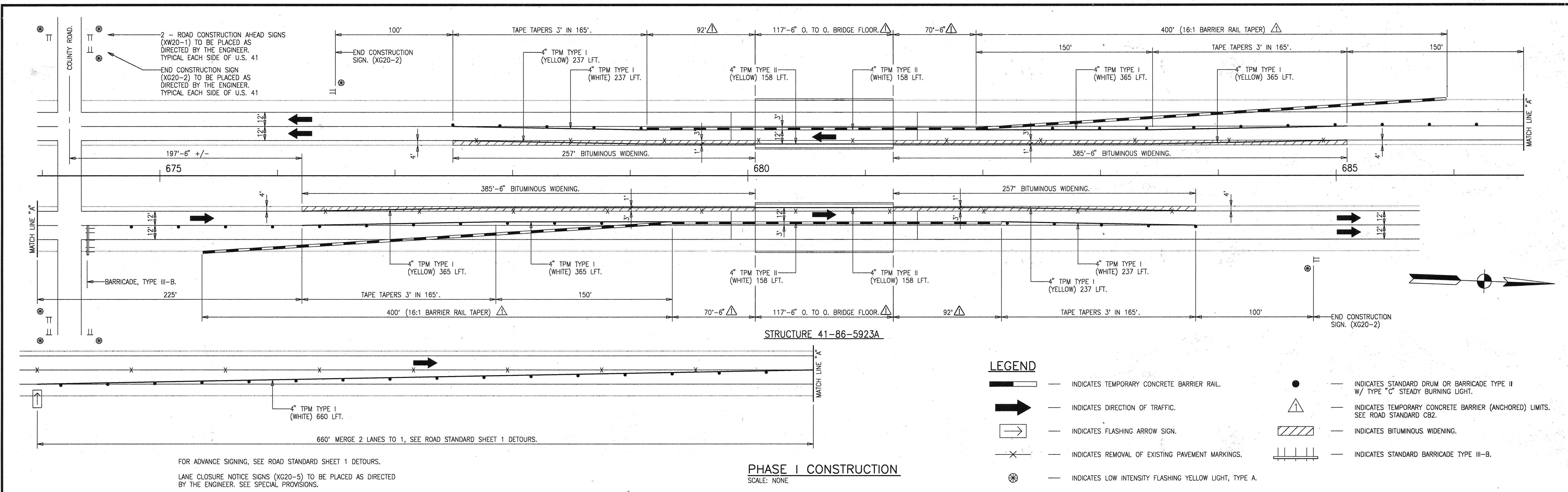

**TRAFFIC MAINTENANCE DETAILS**  
**INDIANA DEPARTMENT OF TRANSPORTATION**

SCALE: AS SHOWN DATE: DECEMBER 2, 1991  
 SUBMITTED FOR APPROVAL: *Richard J. O'Connor*  
 DRAWING: OF SHEET: 2 OF 27  
 PROJECT: F/O19-0 (011)  
 BRIDGE CONTRACT NO: B-19919  
 BRIDGE FILE: 41-86-5923A

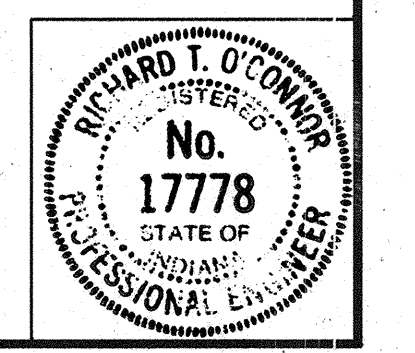

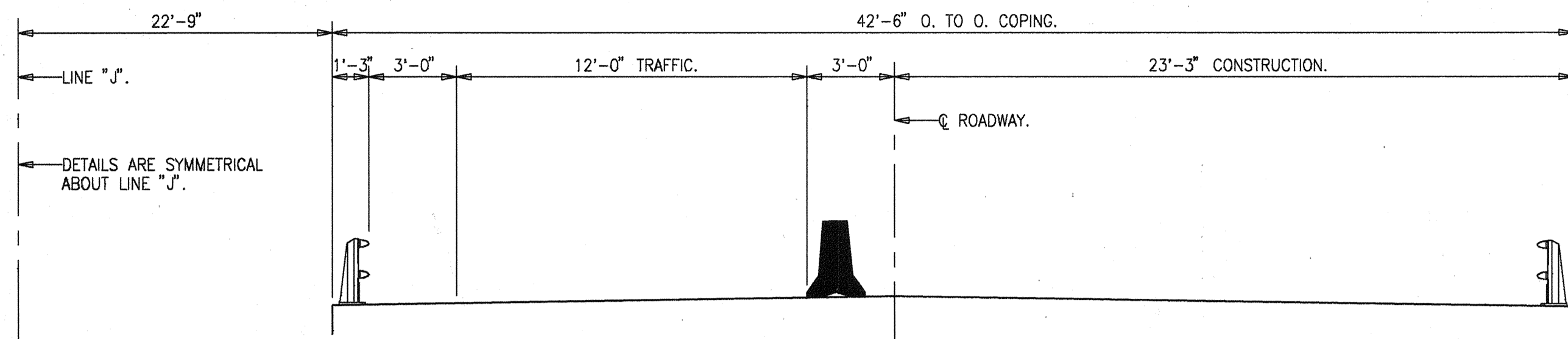

STRUCTURE NO. 41-86-5923A

TYPICAL SECTION - PHASE I

SCALE: 1/4" = 1'-0"

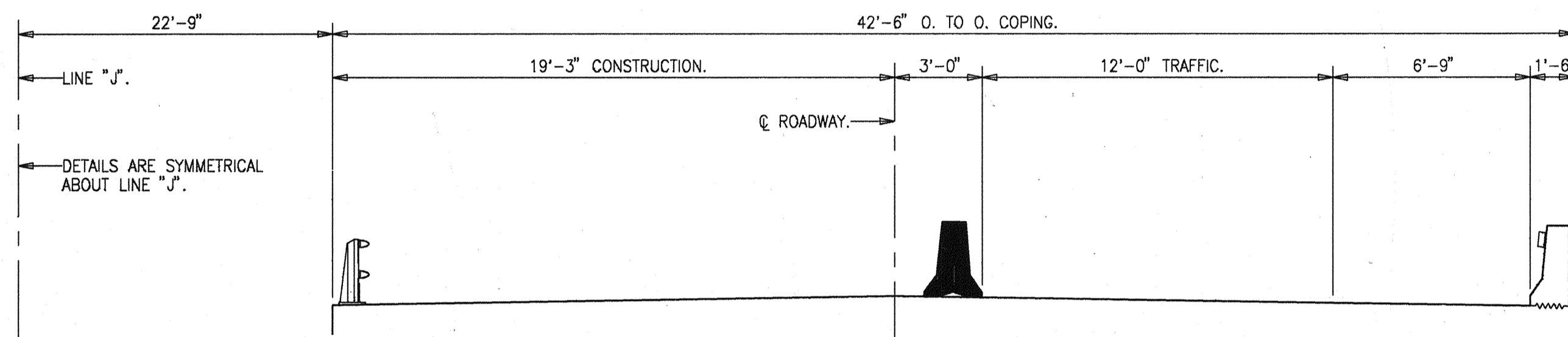

STRUCTURE NO. 41-86-5923A

TYPICAL SECTION - PHASE II

SCALE: 1/4" = 1'-0"

SEPARATE PAY ITEMS

MAINTAINING TRAFFIC	1 LSUM.
TEMPORARY CONCRETE BARRIER (ANCHORED)	1,360 LFT.
CONSTRUCTION SIGNS, A	22 EACH
CONSTRUCTION SIGNS, B	4 EACH
LINE, PAINT, SOLID, YELLOW, 4 IN.	1,520 LFT.
LINE, PAINT, SOLID, WHITE, 4 IN.	1,520 LFT.
LINE, PAINT, BROKEN, WHITE, 4 IN.	410 LFT.
LINE, REMOVE	3,053 LFT.
TEMPORARY PAVEMENT MARKING, I, WHITE, 4 IN.	4,044 LFT.
TEMPORARY PAVEMENT MARKING, I, YELLOW, 4 IN.	4,044 LFT.
TEMPORARY PAVEMENT MARKING, II, WHITE, 4 IN.	316 LFT.
TEMPORARY PAVEMENT MARKING, II, YELLOW, 4 IN.	316 LFT.
STANDARD BARRICADE, III-B	1 EACH
FLASHING ARROW SIGN	240 DAYS
BITUMINOUS MIXTURE FOR APPROACHES, LV. (WIDENING)	548 TONS

\* - COST OF STANDARD DRUMS BARRICADES TYPE II SHALL BE INCLUDED IN THE COST OF "MAINTAINING TRAFFIC", LSUM.

LINE REMOVAL NOTES

THE EXISTING BROKEN WHITE CENTERLINE ALONG THE 660' TAPER ON THE SOUTH END OF THE STRUCTURE (NORTHBOUND LANES) & ON THE NORTH END OF THE STRUCTURE (SOUTHBOUND LANES) SHALL BE REMOVED PRIOR TO PHASE I CONSTRUCTION.

THE EXISTING SOLID YELLOW LINE ALONG THE EXISTING EDGE OF PAVEMENT (INSIDE SHOULDER) FROM THE BEGINNING OF THE 165' TAPER TO THE END OF THE 165' TAPER ON THE OPPOSITE END OF THE STRUCTURE SHALL BE REMOVED PRIOR TO PHASE I CONSTRUCTION. (SOUTHBOUND & NORTHBOUND LANES)

THE EXISTING SOLID WHITE LINE ALONG THE EXISTING EDGE OF PAVEMENT (OUTSIDE SHOULDER) FROM THE BEGINNING OF THE 165' TAPER TO THE BEGINNING OF THE BRIDGE APPROACH & FROM THE END OF THE BRIDGE APPROACH TO THE END OF THE 165' TAPER ON THE OPPOSITE END OF THE STRUCTURE SHALL BE REMOVED PRIOR TO PHASE II CONSTRUCTION. (SOUTHBOUND & NORTHBOUND LANES)

NOTES

BITUMINOUS WIDENING TO REMAIN IN PLACE.

COST OF BITUMINOUS WIDENING TO BE PAID FOR AS "BITUMINOUS MIXTURE FOR APPROACHES, LV" IN TONS.

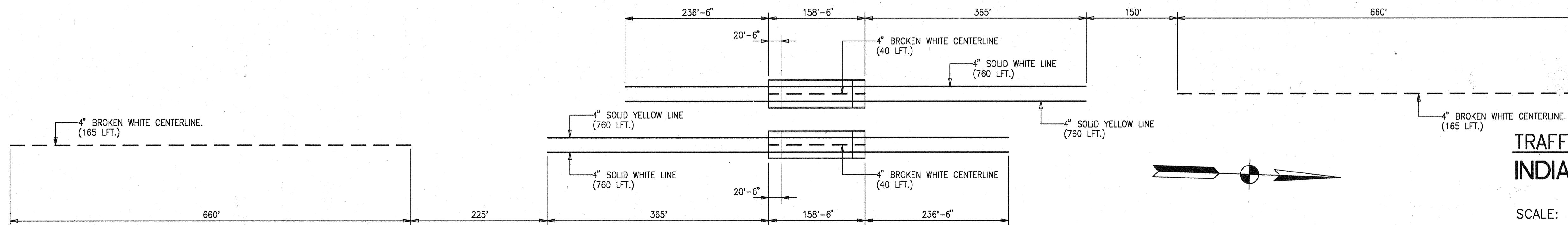

STRUCTURE 41-86-5923A

PAVEMENT MARKINGS

SCALE: NONE

TRAFFIC MAINTENANCE DETAILS  
INDIANA DEPARTMENT OF TRANSPORTATION

SCALE: AS SHOWN DATE: DECEMBER 2, 1991

SUBMITTED FOR APPROVAL: *Richard J. O'Connor*

DRAWING: OF SHEET: 3 OF 27

PROJECT: F/019-0 (011)

BRIDGE CONTRACT NO: B-19919

BRIDGE FILE: 41-86-5923A

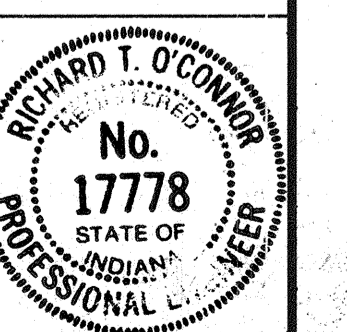

11-14-91 1:00PM - 3:30PM  
 Scale: 1" = 48,000'  
 Time: 11/27/91 at 09:34  
 GKN

DRAWN	GKN (11/21) CHK.	SCJ
DESIGNED	CHK.	
TRACED	CHK.	

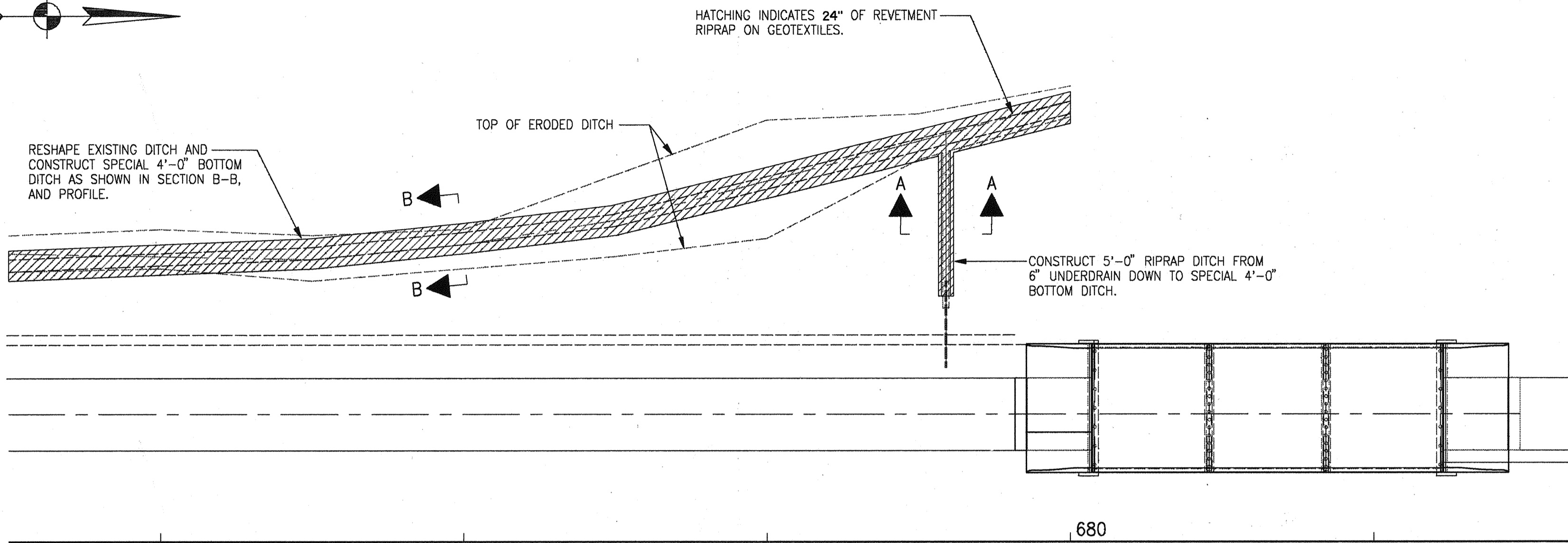
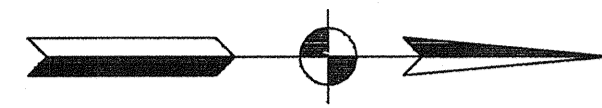

**DITCH SITUATION PLAN**  
SCALE: 1" = 30'

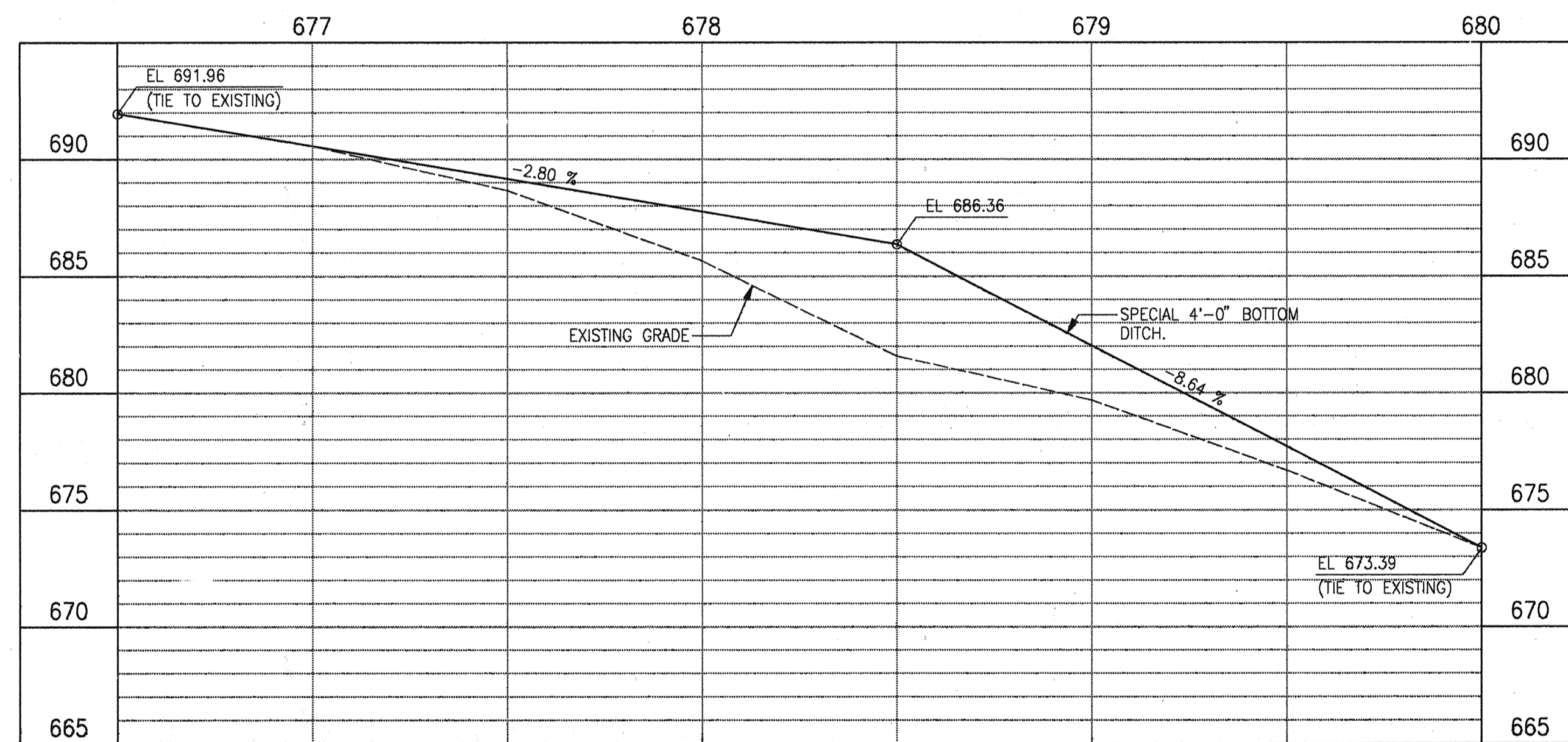

**DITCH PROFILE**  
SCALE: 1" = 30'-0" HORIZ.  
1" = 5'-0" VERT.

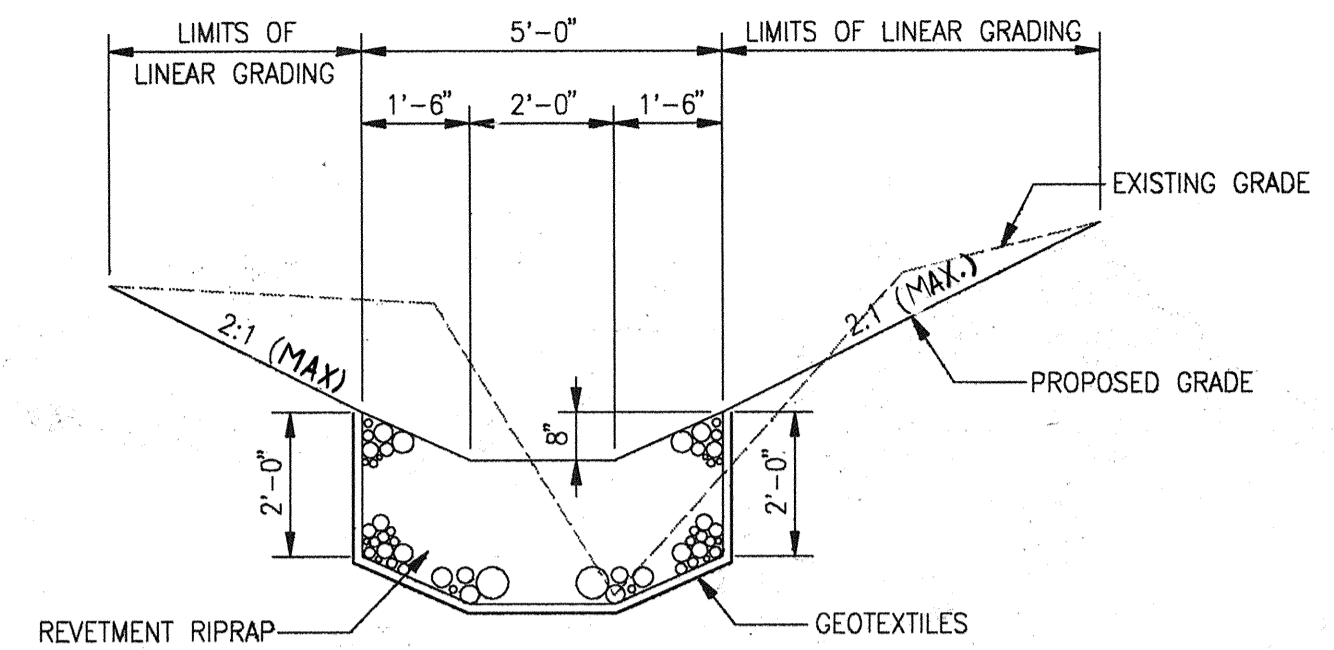

**SECTION A-A**  
SCALE: 3/8" = 1'-0"

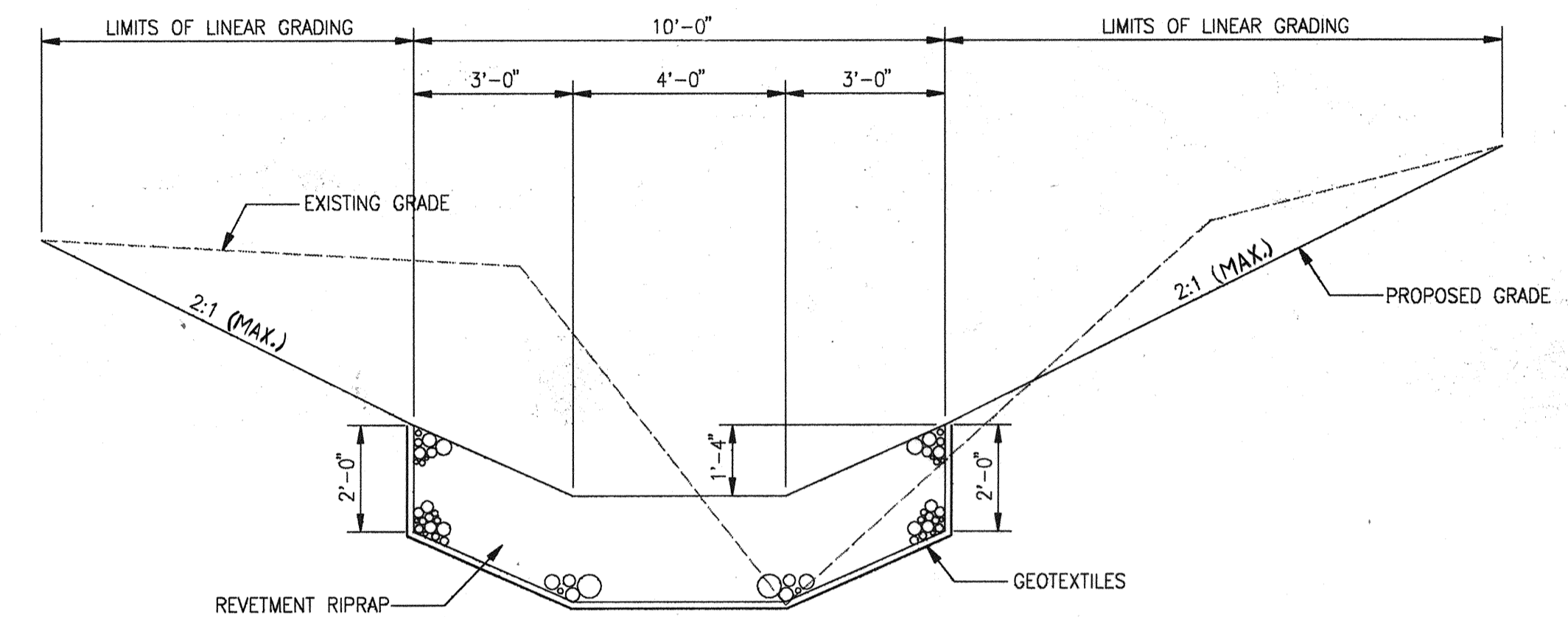

**SECTION B-B**  
SCALE: 3/8" = 1'-0"

**BILL OF MATERIALS**

MISCELLANEOUS	(QTY.)
REVTMENT RIPRAP	566 TONS
GEOTEXTILES	631 SYS.
LINEAR GRADING *	4.0 STA.

\* INCLUDES MULCH SEEDING

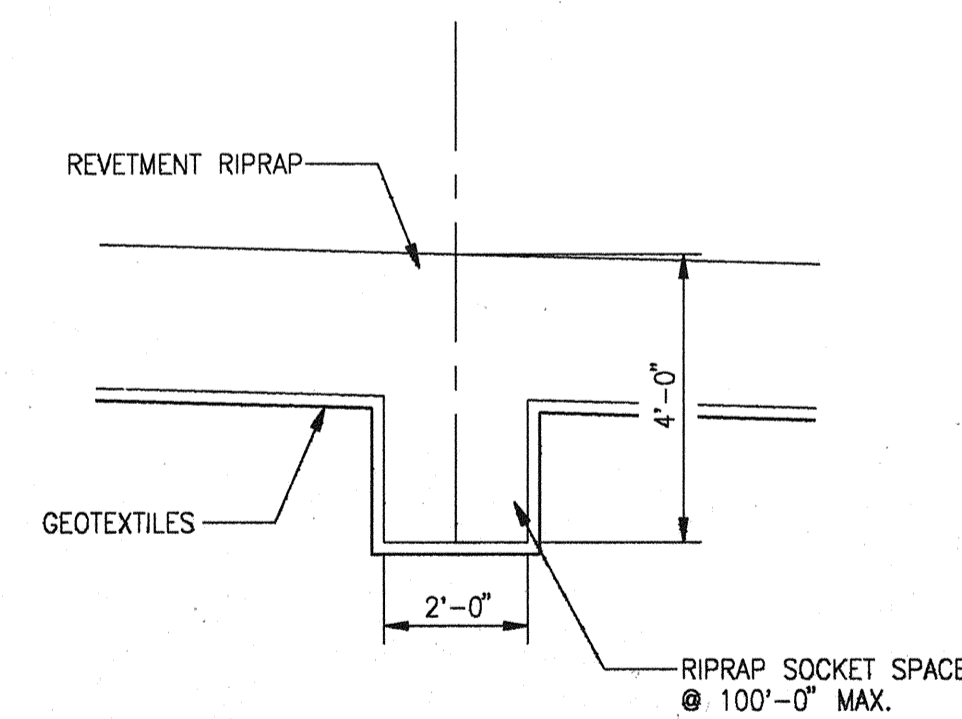

**RIPRAP SOCKET DETAIL**  
SCALE: 3/8" = 1'-0"

**NOTES:**

FOR GENERAL NOTES, SEE DRAWING D2.  
MINIMUM SIZE OF REVTMENT RIPRAP = 12"

**DITCH REPAIR DETAILS**  
**INDIANA DEPARTMENT OF TRANSPORTATION**

SCALE: AS SHOWN DATE: DECEMBER 2, 1991  
 SUBMITTED FOR APPROVAL: *Richard J. O'Connor*  
 DRAWING: D1 OF D5 SHEET: 4 OF 27  
 PROJECT: F/019-0(011)  
 BRIDGE CONTRACT NO: B-19919  
 BRIDGE FILE: 41-86-5923A

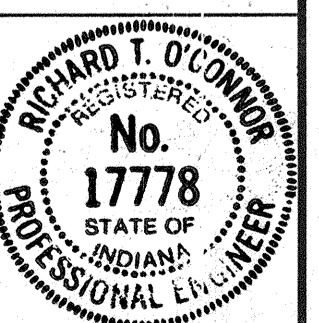

12-09-91 8:30AM 0.17 HOURS D.DUNGAN  
 11-20-91 10:30AM 2.5 HOURS D.DUNGAN

C:\ACAD\10\WORK\60A\328A\DTCH.DWG  
 Date: 12/09/91 at 13:15

DRAWN	DRD	CHK	GKN
DESIGNED		CHK	
TRACED		CHK	

10-06-92 12:00N  
8:00 AM  
4.0 HOURS  
D.DUNNAN

10-02-91 10:45AM  
8:30 AM  
2.25 HOURS  
D.DUNNAN

10-23-91 4:15PM  
7:05 AM  
7.95 HOURS  
D.DUNNAN

10-21-91 5:30PM  
9:54 AM  
7.0 HOURS  
D.DUNNAN

C:\ADAD11\WORK\60A\91013-RP\328A\GEN-PLAN.DWG  
Scale: 10/23/92 at 02:54

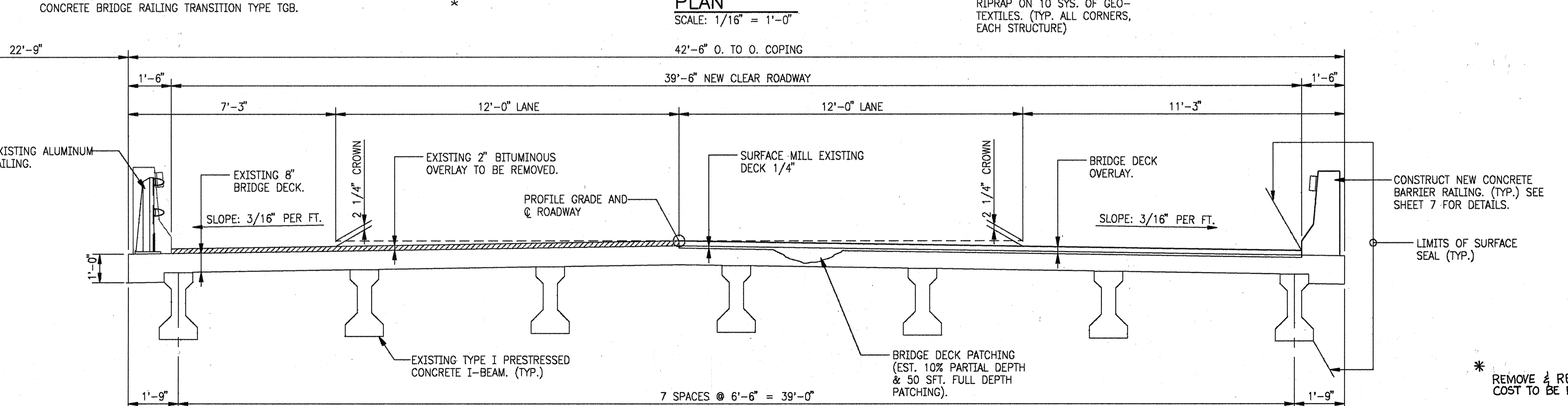
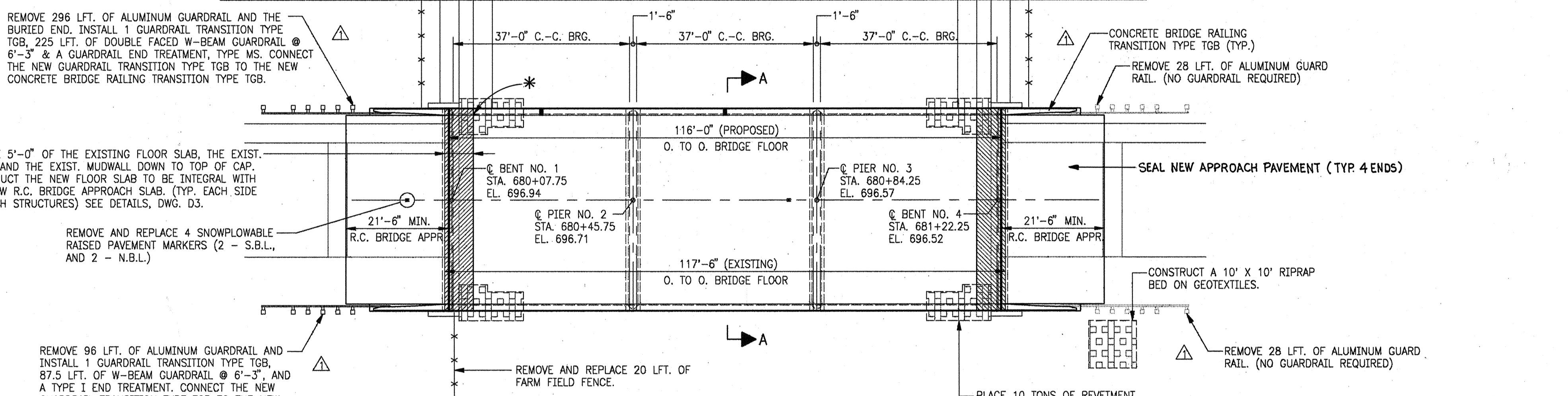
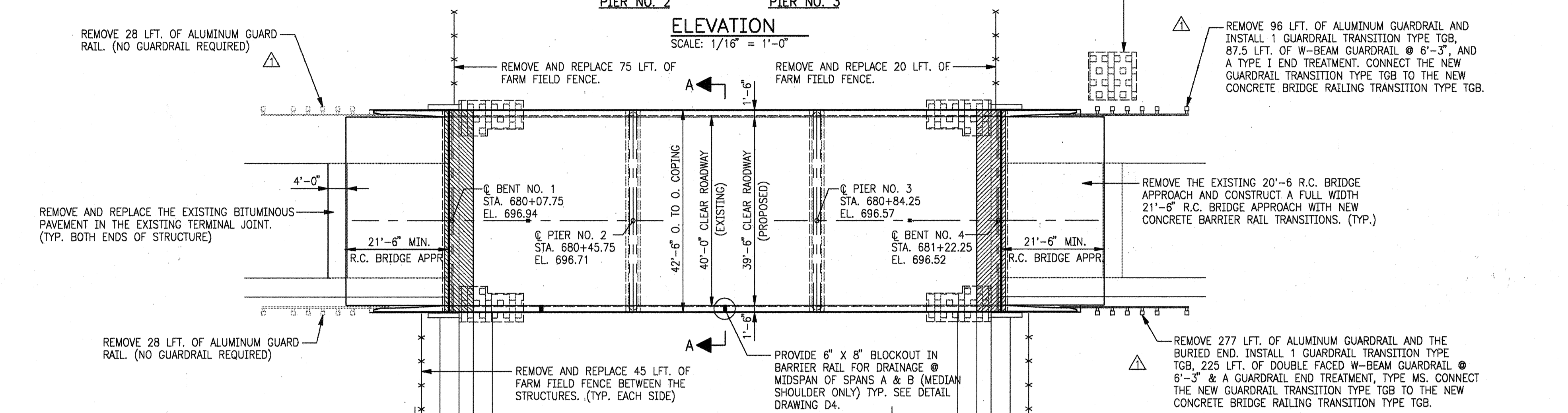
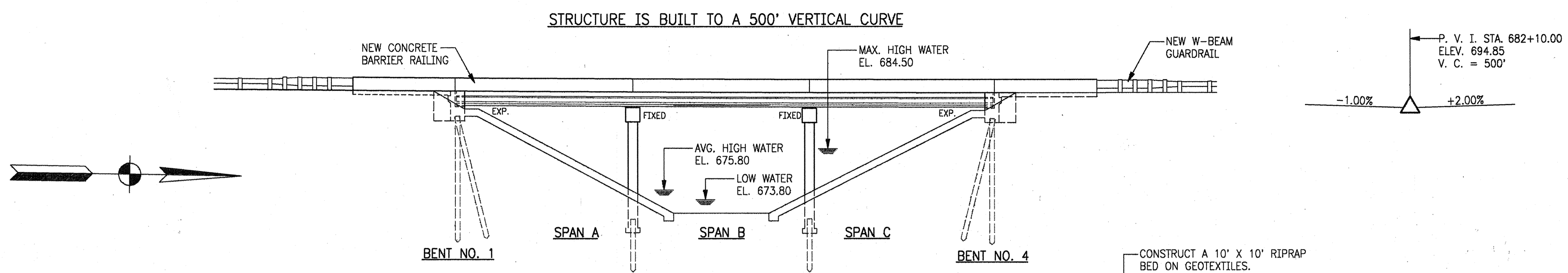

SECTION A-A  
SCALE: 3/8" = 1'-0"

**GENERAL NOTES:**

PLANS FOR THE EXISTING STRUCTURE ARE ON FILE IN THE BRIDGE DEPARTMENT AT THE INDIANA DEPARTMENT OF TRANSPORTATION AS BRIDGE FILE NO. 41-86-5923 AND ARE AVAILABLE UPON REQUEST.

WHERE NEW WORK IS TO BE FITTED TO OLD WORK, THE CONTRACTOR SHALL CHECK ALL DIMENSIONS AND CONDITIONS IN THE FIELD AND REPORT ANY ERRORS OR DISCREPANCIES TO THE ENGINEER AND ASSUME RESPONSIBILITY FOR THEIR CORRECTNESS AND THE FIT OF THE NEW PART TO OLD.

CONCRETE FOR PATCHES IN DETERIORATED DECK AREAS SHALL BE BRIDGE DECK PATCHING CONCRETE OR BRIDGE DECK OVERLAY MATERIAL.

THE HAND CHIPPING AND CLEANING OF DETERIORATED DECK AREAS SHALL BE AS DIRECTED BY THE ENGINEER. IT IS THE INTENT OF THESE PLANS THAT ALL SUCH DETERIORATED CONCRETE BE REMOVED, AND SHOULD THERE BE ANY DOUBT AS TO THE QUALITY OF THE CONCRETE, REMOVAL SHALL CONTINUE UNTIL PERFECTLY SOUND CONCRETE IS EXPOSED.

THE BOUNDARIES FOR PARTIAL DEPTH REMOVAL AREAS SHALL BE SAW CUT. ALL SAW CUTS FOR REMOVALS SHALL BE MADE TO A MINIMUM DEPTH OF 1" BELOW THE ORIGINAL SURFACE OR TO THE TOP OF THE REINFORCING IF COVER IS LESS THAN 1".

FOR CONCRETE REMOVAL EQUIPMENT, SEE ARTICLE 202.03(b) OF THE STANDARD SPECIFICATIONS.

CONCRETE IN SUPERSTRUCTURE AND RAILINGS TO BE CLASS C.

CHAMFER EXPOSED EDGES 1" UNLESS NOTED.

SEAL ALL EXPOSED CONCRETE SURFACES, AS NOTED ON THE PLANS, WITH AN APPROVED SEALER. SEE SUPPLEMENTAL SPECIFICATIONS SECTION 709.05.

CONSTRUCT RIPRAP AT LOCATIONS SHOWN ON THE GENERAL PLAN.

ALL BITUMINOUS MATERIAL IN THIS CONTRACT TO BE INCLUDED IN THE PAY ITEM "BITUMINOUS MIXTURE FOR APPROACHES, LV" EXCEPT TACK COAT WHICH SHALL BE PAID FOR AS "BITUMINOUS MATERIAL FOR TACK COAT" IN SQUARE YARDS, AND TERMINAL JOINT, WHICH SHALL BE PAID FOR AS "BITUMINOUS MIXTURE FOR APPROACHES, HV".

**MATERIAL NOTES:**

BRIDGE DECK OVERLAY:

- 2 1/4" MODIFIED PORTLAND CEMENT CONCRETE OVERLAY OR
- 2 1/2" DENSE PORTLAND CEMENT CONCRETE OVERLAY

TERMINAL JOINT:

110 POUNDS PER SQUARE YARD H.A.C. SURFACE TYPE II, HV OVER VARIABLE DEPTH BITUMINOUS BINDER, HV OR BASE, HV.

BITUMINOUS WIDENING:

990 POUNDS PER SQUARE YARD BITUMINOUS BASE, (TYPE NO. 5D), LV.

**SEPARATE PAY ITEMS**

BRIDGE DECK OVERLAY, REMOVE	1,090 SYS.
SURFACE MILLING, PORTLAND CEMENT CONCRETE	1,026 SYS.
BRIDGE DECK PATCHING, FULL DEPTH	100 SFT.
BRIDGE DECK PATCHING, PARTIAL DEPTH	981 SFT.
BRIDGE DECK OVERLAY	1,018 SYS.
BRIDGE DECK OVERLAY, ADDITIONAL	9.0 CYS.
GUARDRAIL, REMOVE	1,037 LFT.
GUARDRAIL, W-BEAM, 6'-3" SPACING	175 LFT.
GUARDRAIL, W-BEAM, DOUBLE FACED, 6'-3" SPACING	450 LFT.
GUARDRAIL END TREATMENT, TYPE I	2 EACH
GUARDRAIL END TREATMENT, TYPE MS	2 EACH
GUARDRAIL TRANSITION TYPE TGB	4 EACH
BRIDGE RAILING, REMOVE	461 LFT.
BITUMINOUS MIXTURE FOR APPROACHES, HV	22 TONS
FENCE, FARM FIELD, REMOVE	205 LFT.
FENCE, FARM FIELD, 47 IN.	205 LFT.
SNOWPLOWABLE, RAISED, PAVEMENT MARKERS, REMOVE	4 EACH
SNOWPLOWABLE, RAISED, PAVEMENT MARKERS	4 EACH
RETVEMENT RIPRAP	104 TONS
GEOTEXTILES	116 SYS.

**GENERAL PLAN**

TWIN CONTINUOUS PRESTRESSED CONCRETE I-BEAM BRIDGES  
3 SPANS @ 37'-0" EACH

SKEW: SQUARE OVER 39'-6" (NEW) CLEAR ROADWAY  
U.S. 41 OVER NAMELESS CREEK

**INDIANA DEPARTMENT OF TRANSPORTATION**  
WARREN COUNTY

SCALE: AS SHOWN DATE: DECEMBER 2, 1991

SUBMITTED FOR APPROVAL: *Richard J. O'Connor*  
DRAWING: D2 OF D5 SHEET: 5 OF 27

PROJECT: F/019-0(011)  
BRIDGE CONTRACT NO: B-19919  
BRIDGE FILE: 41-86-5923A

\* REMOVE & RESET EXISTING BENCH MARK. COST TO BE INCLUDED IN COST OF OTHER ITEMS.

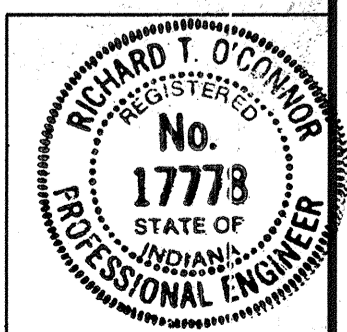





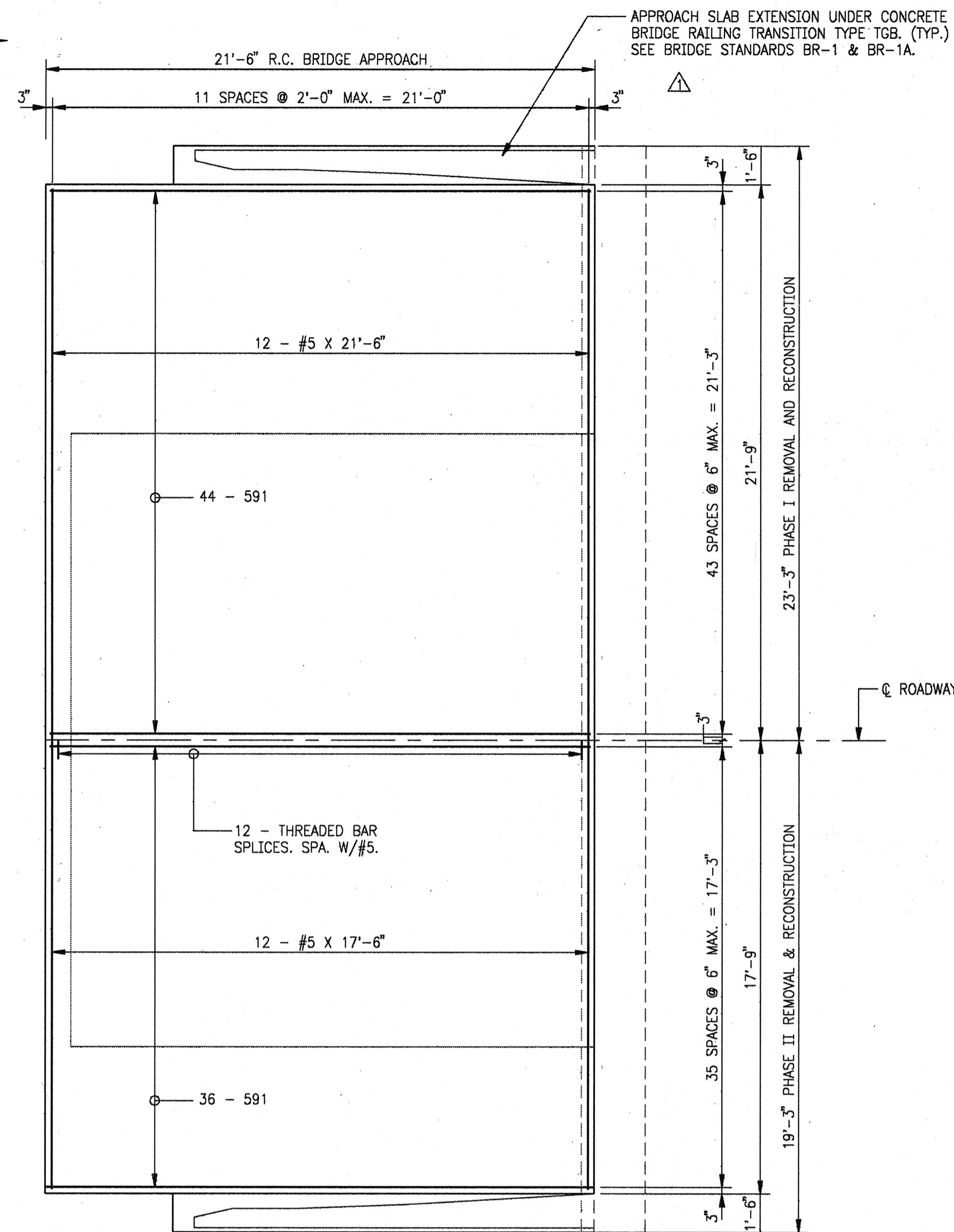
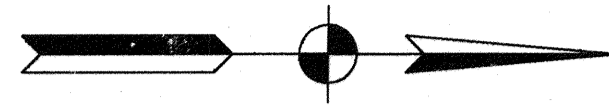

APPROACH PLAN (4 THUS)  
SCALE: 1/4" = 1'-0"

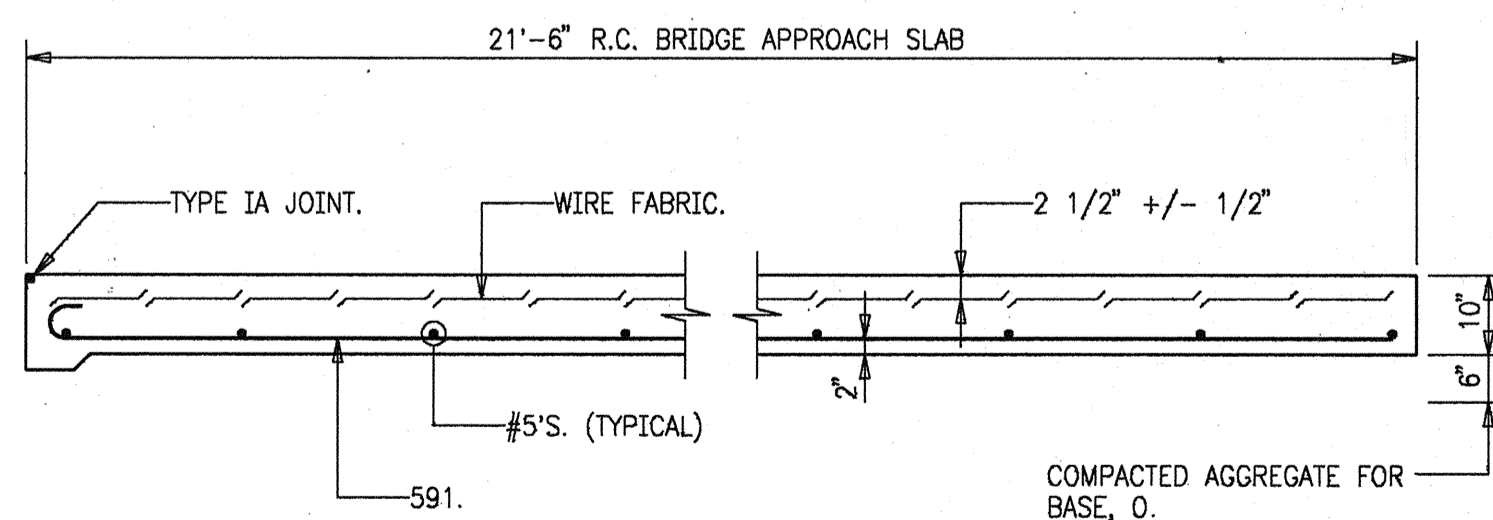

TYP. SECTION THRU APPROACH  
SCALE: 1/2" = 1'-0"

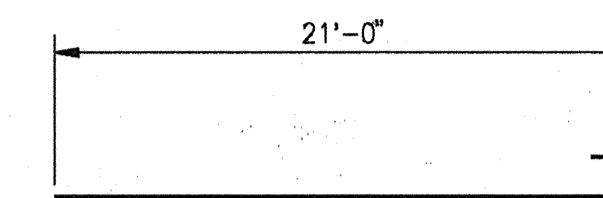

591 X 21'-7" △

BILL OF MATERIALS △

PLAIN REINFORCING STEEL			
SIZE & MARK	NO. OF BARS	LENGTH	WEIGHT (LBS.)
591	320	21'-7"	
#5	48	21'-6"	
#5	48	17'-6"	
TOTAL #5			9,156
TOTAL PLAIN REINFORCING			9,156
EPOXY COATED REINFORCING STEEL			
8 APPR. SLAB EXTENSIONS @			
@ 375 LBS. EACH =			3,000
(FROM BR. STD. BR-1A)			
TOTAL EPOXY COATED REINFORCING			3,000
MISCELLANEOUS			(QTY.)
SURFACE SEAL (ESTIMATED)			1,050 SFT.
CEMENT CONCRETE PAVEMENT, REINFORCED, 10 INCH			400 SYS.
COMPACTED AGGREGATE FOR BASE, TYPE O.			135 TONS
CONC. BRIDGE RAILING TRANSITION, TGB			8 EACH
THREADED BAR SPLICES			48 EACH
PAVEMENT, REMOVE			255 SYS.

\* INCLUDES 22 SYS. FROM BRIDGE STANDARD BR-1A (8 EXTENSIONS @ 2.75 SYS. EACH)  
QUANTITIES ARE FOR ALL 4 APPROACHES

NOTES:

- FOR GENERAL NOTES, SEE DRAWING D2.
- FOR CONCRETE BARRIER RAIL TRANSITION DETAILS, SEE SHEET 9.
- FOR ADDITIONAL R.C. BRIDGE APPROACH DETAILS SEE ROAD STANDARD SHEET B.
- FOR REINFORCING BAR NOTES, SEE BRIDGE STANDARD C1.
- \* - INDICATES EPOXY COATED REINFORCING.

APPROACH DETAILS  
INDIANA DEPARTMENT OF TRANSPORTATION

SCALE: AS SHOWN DATE: DECEMBER 2, 1991  
SUBMITTED FOR APPROVAL: *Richard T. O'Connor*  
DRAWING: D5 OF D5 SHEET: 8 OF 27  
PROJECT: F/019-0(011)  
BRIDGE CONTRACT NO: B-19919  
BRIDGE FILE: 41-86-5923A

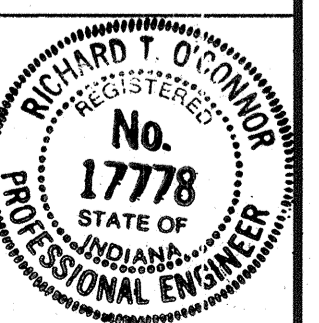

11-14-91 1:00PM 3:30PM  
D. DUNCAN  
C:\ACAD\1\WORK\60A\91013-RP\3284\APPR-D1.DWG  
Scale: 1/4" = 1'-0"  
Time: 10/23/92 at 02:58

DRAWN	DRD	CHK.	GKN/JET
DESIGNED		CHK.	
TRACED		CHK.	