

**LEGEND**

- 2m OCTAGONAL LOOP, WITH 4 TURN SERIES
- EXIST. 9.2m STRAIN POLE
- PROP. 9.2m STRAIN POLE
- EXIST. HANDHOLE
- EXIST. 1-WAY, 3 SECTION (300mm RED, 300mm AMBER, 300mm GREEN SIGNAL INDICATION)
- EXIST. DETECTOR HOUSING
- PROP. DETECTOR HOUSING
- PROP. 50mm GALVANIZED STEEL CONDUIT
- EXIST. 50mm GALVANIZED STEEL CONDUIT
- EXIST. 4-PHASE MENU-DRIVEN CONTROLLER & CABINET ON NEW "M" FOUNDATION
- PROP. SPAN MOUNT JUNCTION BOX
- POLE MOUNTED PEDESTRIAN SIGNAL INDICATION (2 OF THE 4 FIXTURES ARE EXISTING) (PEDESTAL PUSH BUTTON)
- TRANSVERSE MARKINGS, THERMOPLASTIC, 0.6m STOP BAR LINE
- TRANSVERSE MARKINGS, THERMOPLASTIC, 0.2m CROSS WALK LINE
- LINE, THERMOPLASTIC, SOLID DOUBLE YELLOW 0.1m
- RAISED PAVEMENT MARKERS - BI DIRECTIONAL

**CURVE DATA-LINE A<sub>2</sub>**  
 $\Delta = 00^{\circ}50'53.8''$   
 $R = 20175.293m$   
 $T = 149.352m$   
 $L = 298.699m$

"DON'T DIG BLIND"  
 CALL TWO WORKING DAYS  
 BEFORE YOU DIG

WITHIN INDIANA:  
 1-800-382-5544  
 FROM OUTSIDE INDIANA:  
 1-800-428-5200

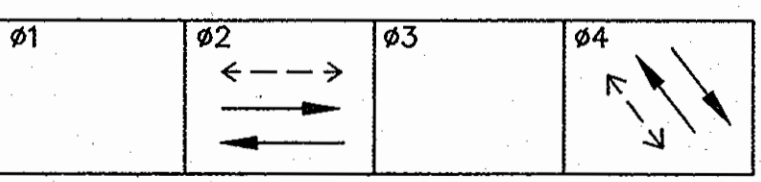
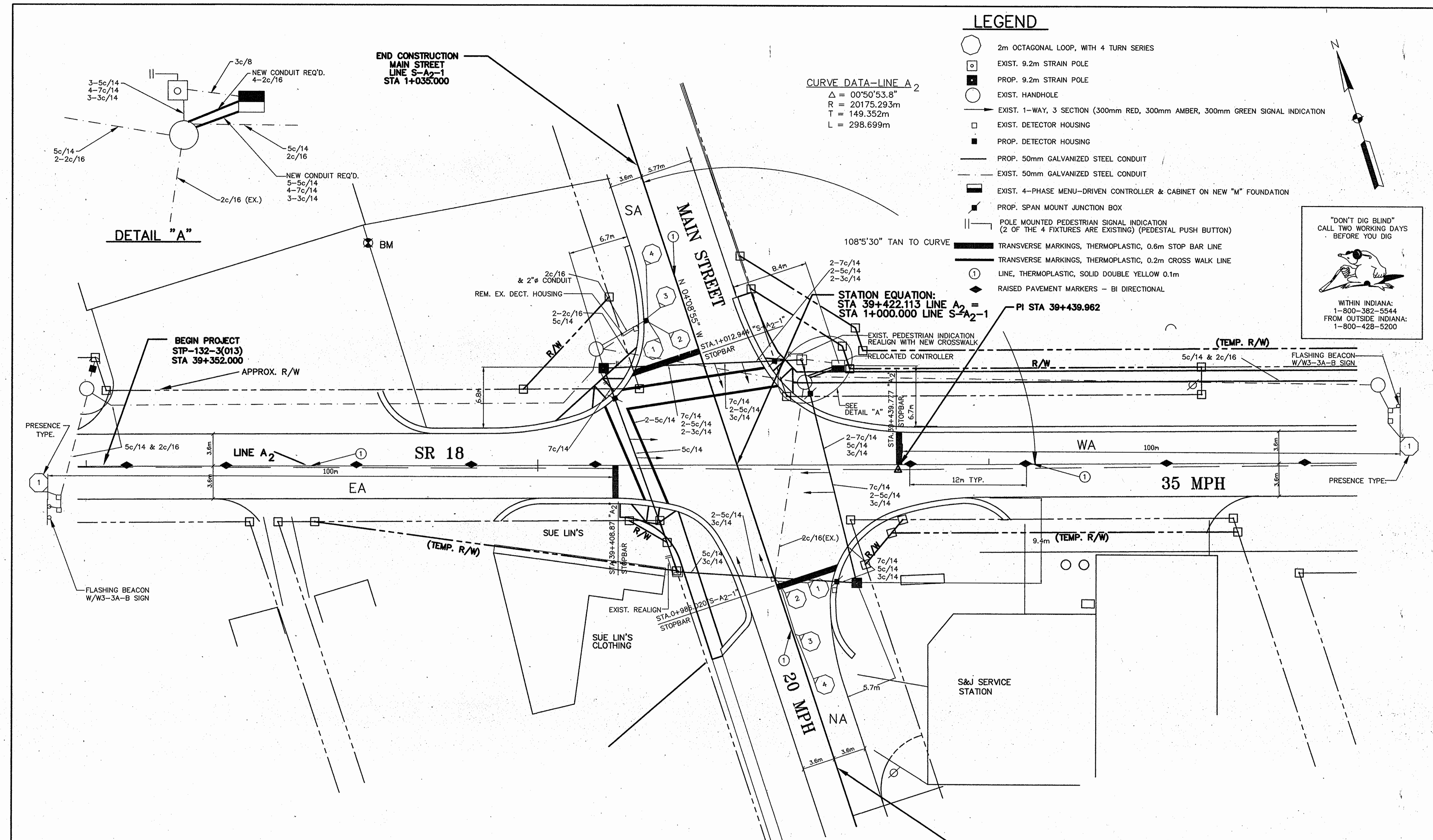

S.R. 18 (DELPHI ST.) IS PREFERENTIAL  
 S.R. 18 (DELPHI ST.) FLASHES AMBER  
 MAIN ST. FLASHES RED

LOOP TAGGING TABLE		
LANE	TAG	NUMBER
NA	NA4	- 1,2,3,4
SA	SA4	- 1,2,3,4
EA	EA2	- 1
WA	WA2	- 1

**COMM. NO. 01-027-041**

SR 18 & 500 WEST (MAIN ST.)  
 SWEETZER, GRANT COUNTY  
 FORT WAYNE DISTRICT

CAD\194282\0-9F Gove Associates, Inc - Indianapolis

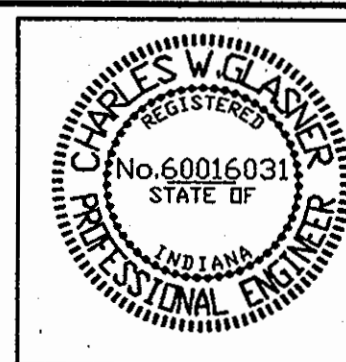

RECOMMENDED FOR APPROVAL: *Charles W. Glanville* 8-18-97  
 DESIGN ENGINEER DATE

DESIGNED: JW DRAWN: JW  
 CHECKED: CWG CHECKED: CWG

**INDIANA DEPARTMENT OF TRANSPORTATION**

TRAFFIC SIGNAL DETAIL  
 LINE A<sub>2</sub> & LINE S-A<sub>2</sub>-1

HORIZONTAL SCALE 1:200	BRIDGE FILE
VERTICAL SCALE NONE	DESIGNATION 8463390
SURVEY BOOK 16335	SHEETS 9 of 16
CONTRACT R-22256	PROJECT STP-132-3(013)

01-027-041